





2.0 LANDSCAPE PRINCIPLES

02



2.1 LANDSCAPE VISION

“Open spaces for everyone now and for the future, enhancing active lifestyles connected to nature”

Vision set out in The Sutherland Shire Open Space Strategy and Implementation Plan

The broader vision for the landscape master plan aligns with the Sutherland Shire vision and vision for the Besmaw Planning Proposal as outlined in the Master Plan Urban Design Report.

The vision is to create a place that celebrates its rich cultural heritage, regenerates the natural environment to provide a connected ecological system and delivers a vibrant and sustainable “home” to those who live, work and play there.

The Besmaw Planning Proposal will evolve into a thriving community enriched by culture, enterprise and social exchange. It is a place which is connected to and contained by a landscape of bays, beach, coast and headland.

The landscape vision is aligned with the overall Master Plan design principles, the Indigenous design principles and landscape design principles to create a cohesive site wide vision. These principles offer a detailed and comprehensive approach to the landscape, public domain, public open spaces and the natural environment.

The landscape master plan design principles are supported by the vision as set out below.



2.2 LANDSCAPE DESIGN PRINCIPLES

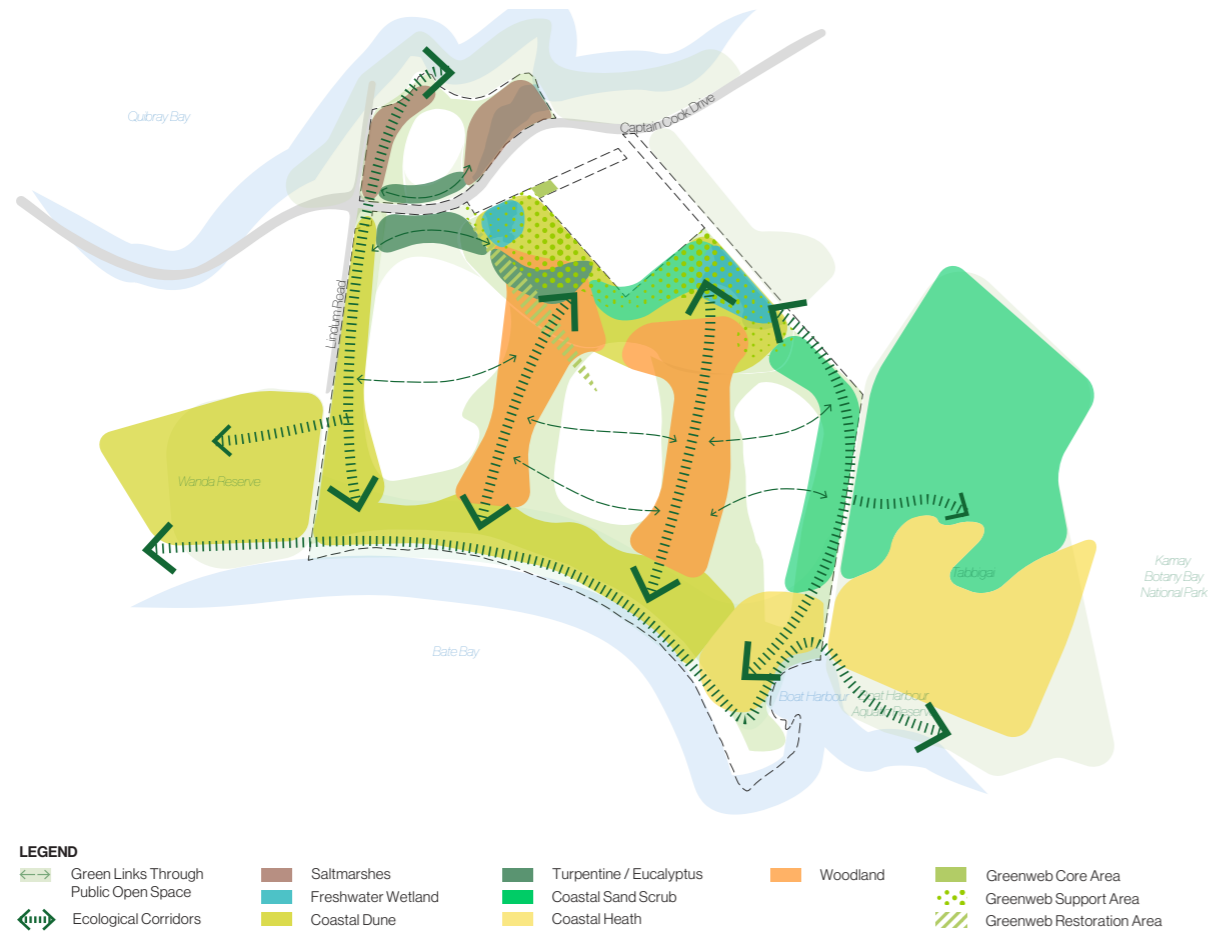

01/

Regenerate ecology, to create a resilient and diverse green network

- Promote rehabilitation efforts to allow free movement of fauna throughout the peninsula, aligned to the aspirations of the Kurnell 2020 Corridor Delineation strategy.
- Create north south ecological links in the site.
- Design a diversity of ecological responses to drive the character, and outcomes of sub precincts within in the Master Plan.
- Strengthen the east-west biodiversity corridor within the Coastal Use Area, preserve coastal vegetation along the southern interface and Boat Harbour.
- Regenerate riparian corridors and coastal vegetation to connect to adjacent ecosystems.
- Develop an integrated green infrastructure system with integrated water management.
- Integrate education and cultural land management.



02/

Engage with, recognise and celebrate Country

- Embed Aboriginal design principles in open space design.
- Leverage natural environment to actively engage with and acknowledge the Indigenous culture of the region.
- Provide place for First Nation peoples and the wider community to reactivate Country.
- Acknowledge and celebrate Country through art interpretation, signage, eco-tones of the site and textures.
- Integrate First Nations cultural management of the landscape.

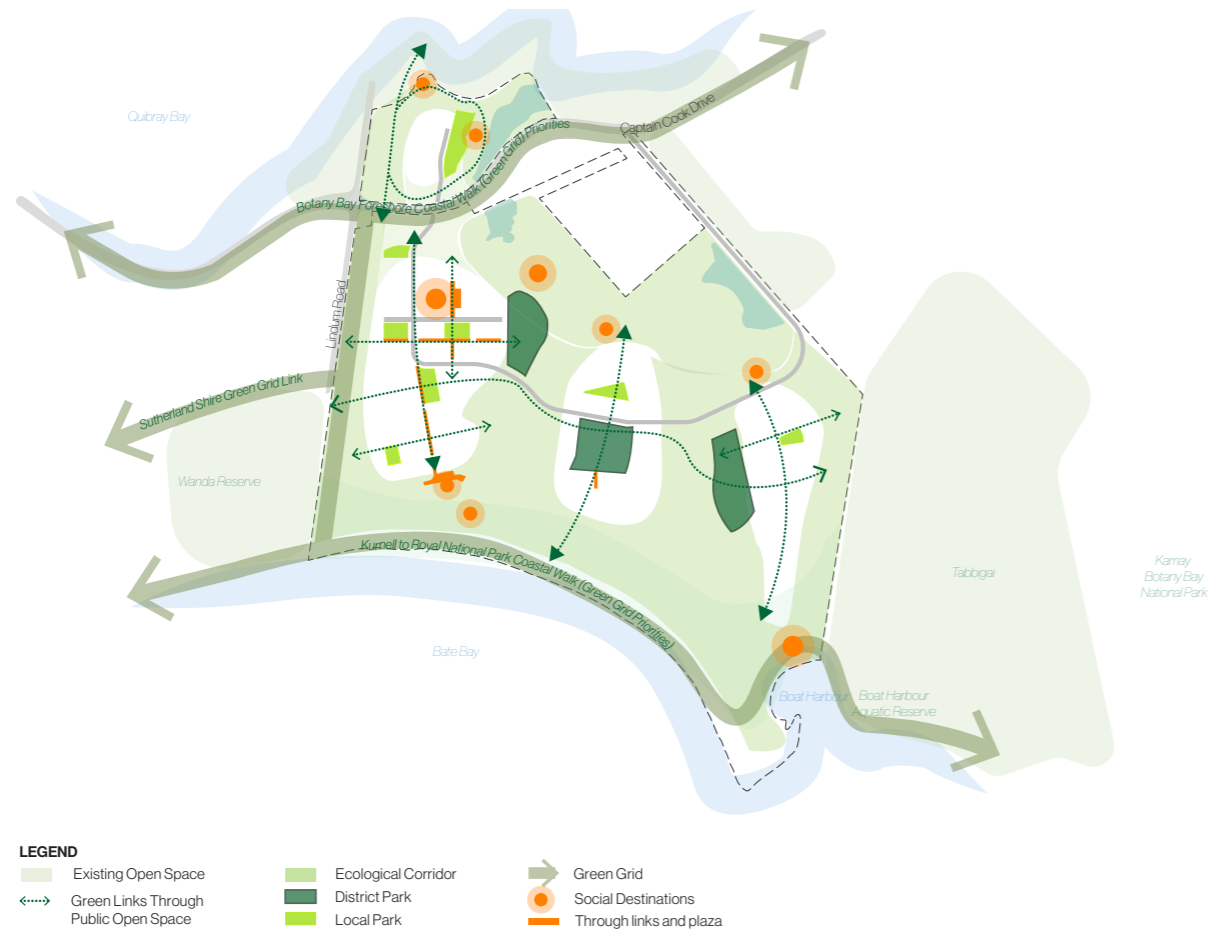

03/

Create a network of places and destinations to reflect the values and character of Kurnell for its community

- Create an open space network that is dynamic and culturally rich to foster community well-being, ecological sustainability and engagement with the surrounding environment.
- Ensure public accessibility throughout the site for the local community and visitors alike.
- Include social infrastructure for community, culture, sports and recreation.
- Establish hierarchy of open space typologies with different uses to meet the open space needs for future community.
- Carefully locate recreational facilities and passive open space to respond to the precinct characters.
- Through site links to create distinctive pedestrian experience.

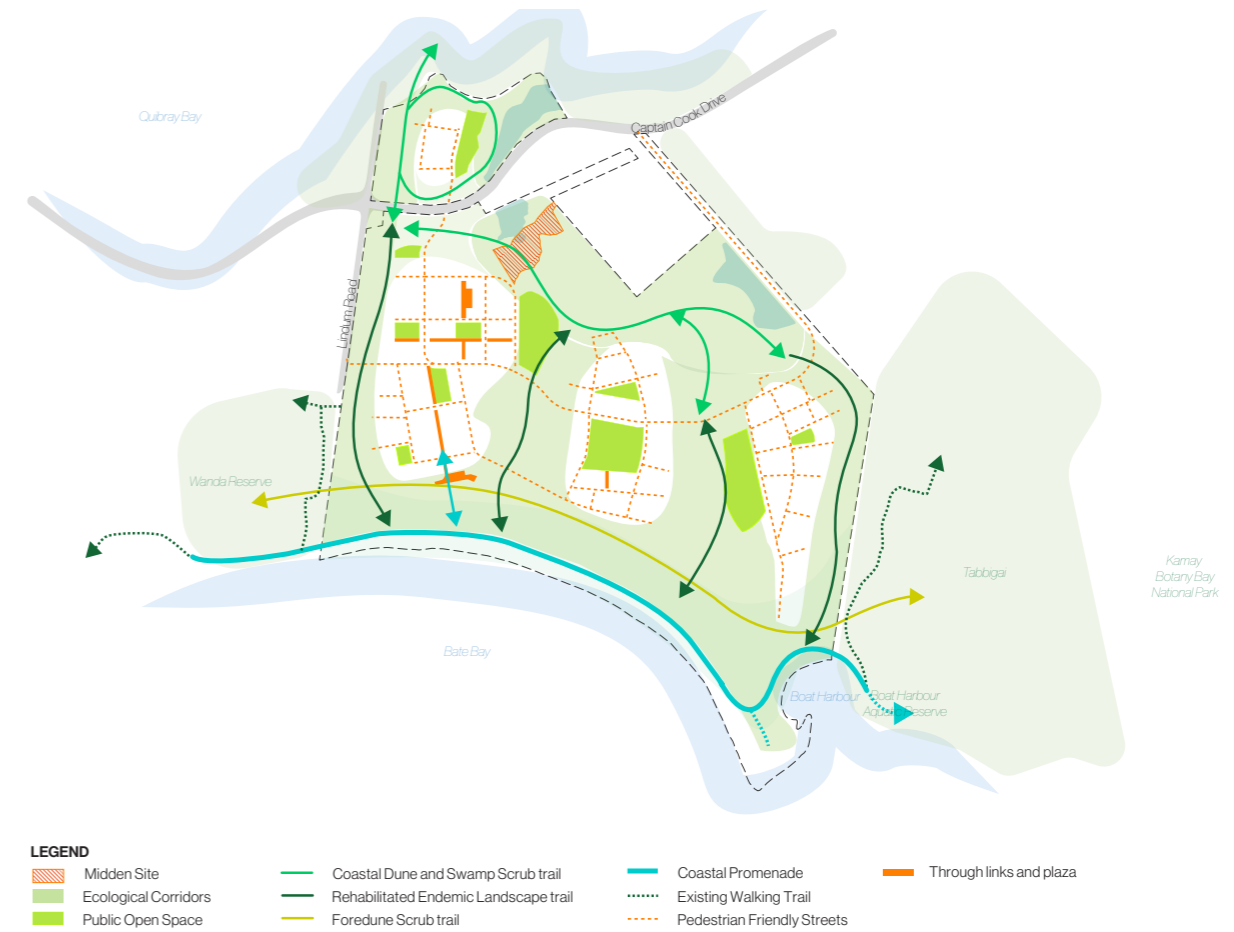

04/

Develop an integrated movement network and embed into open space

- Create Bay to Bay connections and beach to headland coastal connections.
- Strengthen the role of open space and public realm in movement providing safe and comfortable walking environment.
- Design for pedestrian priority and promote active transport.
- Create pedestrian oriented, walkable town centre and neighbourhoods with safe and attractive streetscape.
- Wayfinding strategy throughout the public domain for a legible and accessible pedestrian experience.

2.3 CONNECTION TO COUNTRY

“Country as made up of a series of interconnected elements that come together to form the environmental, cultural and social system of a place. To design with Country is to design with the elements of Country.”

Yerrabingin

The design process has put Country and Landscape at the forefront, to ensure that the proposed master plan holds significant meaning and expression to the site.

This has allowed prioritisation about Country, to establish a pathway and re check and align with Aboriginal values as a way of connecting throughout the project life-cycle. It has also enabled refinement of the current design, and an ongoing commitment of development through co-design to ensure the best outcomes for the project and the community it will serve.

Significant design development has been undertaken in the ecological corridors and public open space to explore the relationship between Country the biodiversity outcomes for the site. Aboriginal peoples' continued connection with Country is source of valuable wisdom and knowledge that has been used to guide the way we plan and design the places where we live, work, and play.

The Connecting with Country engagement process has been led by Yerrabingin and followed their Wanggani Dhayar design process. Yerrabingin facilitated a Design Jam, following the Walk on Country to start mapping and drawing out the opportunities. Yerrabingin developed three overarching Connecting with Country design principles that are regeneration, resilience and reignition.

Connecting with Country Design Principles



Regeneration

Understanding the evolving nature of ecological systems on site. Consider how proposed design interventions interact with, and in turn, support the future success of these social, cultural, and environmental systems.

Features:

- Aspect and city views
- Eco corridors for human and non-human kin to traverse safely and freely across precincts
- Ecological continuity
- Maximised opportunities for planting
- Architectural point of difference within Sydney
- Open space to facilitate connections to water and sky Country.



Resilience

Exploring how we can nurture cultural and spiritual connections to Country through a de-colonial, interpretive, and educational lens. Bringing First Nations community back to Country with a focus on rehabilitating both environmental and social relationships.

Features:

- Accessible meandering pathways throughout the site
- First Nations led tours, sharing stories and significance of cultural sites (middens)
- Focus on endemic planting
- Demonstration of shared custodianship

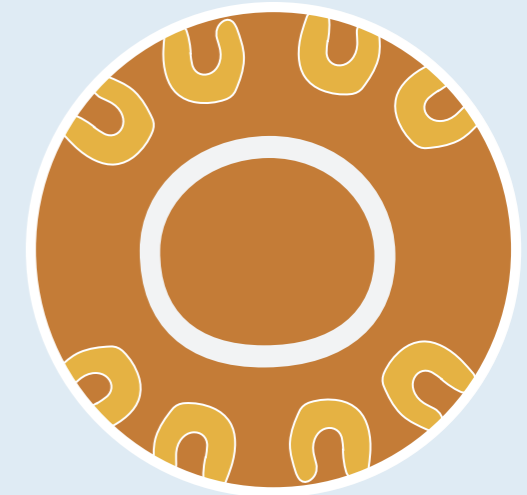

Reignition

Providing place and space for First Nations peoples and the wider community to reactivate Country. Opportunity to support, foster, and develop sociocultural exchange through micro businesses, social enterprise, cultural land management, and productive landscapes.

Features:

- Incorporates traditional land care practices within the ongoing management of the site (burning)
- Accessible pathways both within the site and connected to broader regions (connection to national Park Trails and Wanda Reserve)
- Dedicated camping ground for all to enjoy
- Opportunity for First Nations social enterprise

Opportunities



Storytelling opportunities led by First Nations community members



Meeting Place for cultural and knowledge exchanges



First Nations Employment and Enterprise Opportunities



Cultural Practices embedded within activations on site



Plant and Habitat Regeneration is fundamental to site



Art and Wayfinding interlinking across site

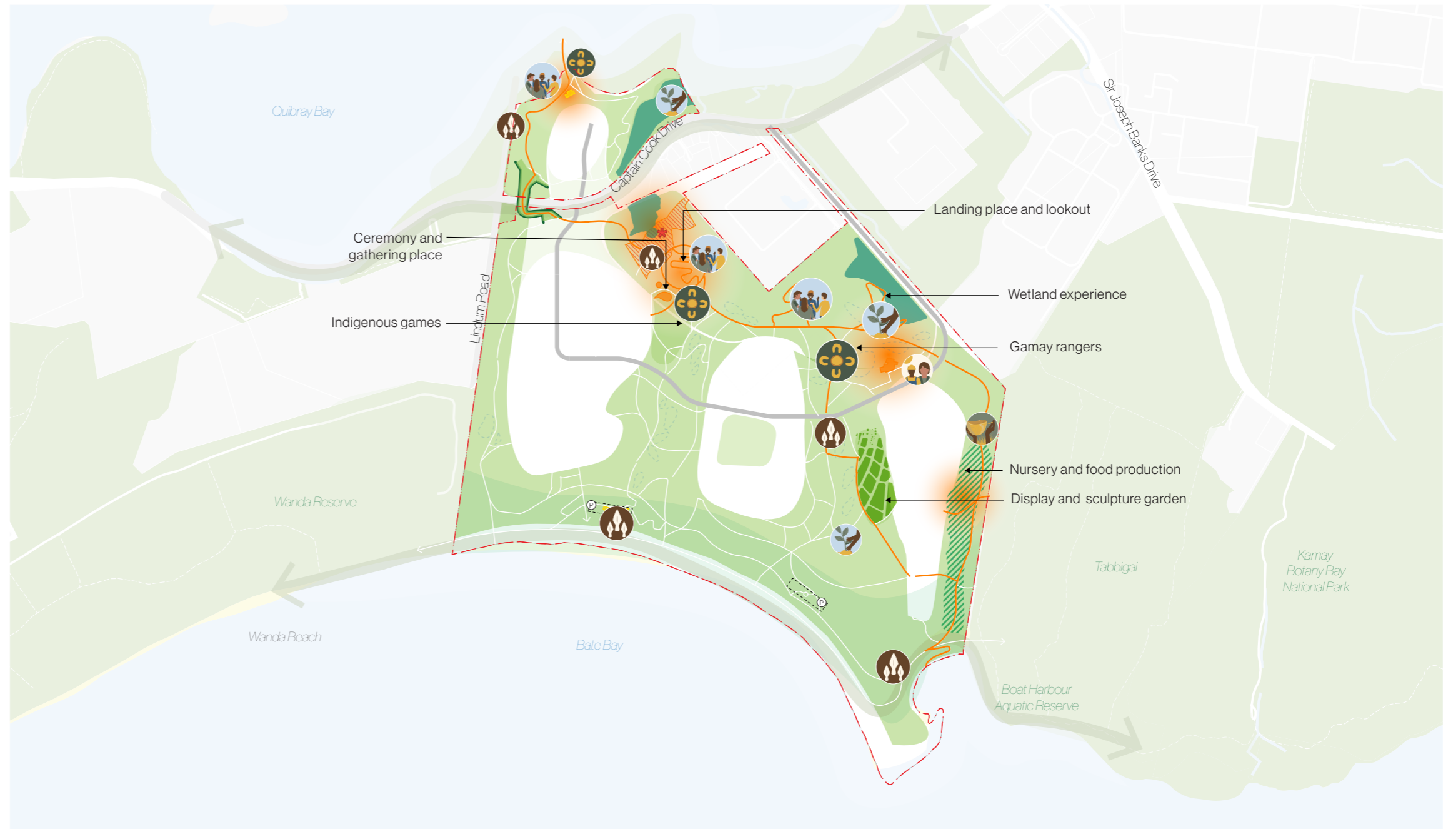

LEGEND

- Subject Site
- Midden Site
- Natural Habitat

- Cultural Destination
- Cultural Trail
- Underground Public Parking

- Protected Wetland
- Eco Bridge
- Recreational Open Space

- Nursery

